

8 CEDAR COURT

Bishops Waltham, SO32 1DX
Asking Price £249,950

WELLER
PATRICK



PROPERTY FEATURES

A two-bedroom mid-terrace retirement property in a desirable location in the popular town of Bishops Waltham

Fitted kitchen • Spacious living/dining room with doors to communal garden

Two bedrooms • Bathroom • Downstairs shower room

Viewing highly recommended • No forward chain



DESCRIPTION

Cedar Court is a conveniently situated small and established scheme of retirement properties in Bishops Waltham within a short distance of the town centre.

The property enjoys a pleasant position with a courtyard setting and communal gardens.

The property benefits from two double bedrooms, a bathroom, ground floor shower room, kitchen and a lounge/dining room with patio doors opening onto the communal gardens.

Bishops Waltham is extremely popular and desirable with a thriving community and a most attractive traditional high street with a range of shops, services, restaurants and coffee shops.

The property is being offered for sale with no forward chain. Early viewing is recommended.

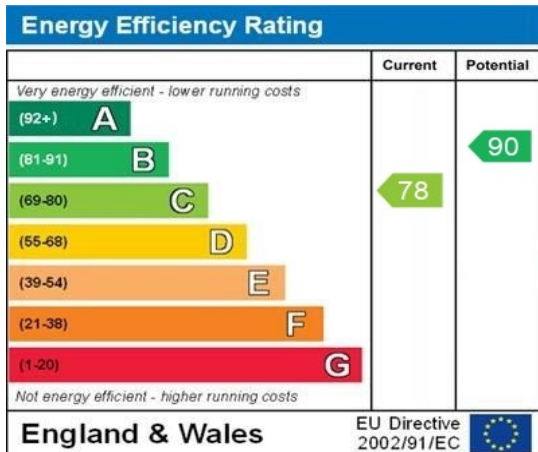

WWW.EPC4U.COM



8 Cedar Court
Bishops Waltham
SO32 1DX



LOCAL AUTHORITY AND SERVICES
Winchester City Council

Council Tax band C

Main services

GROUND FLOOR

1ST FLOOR

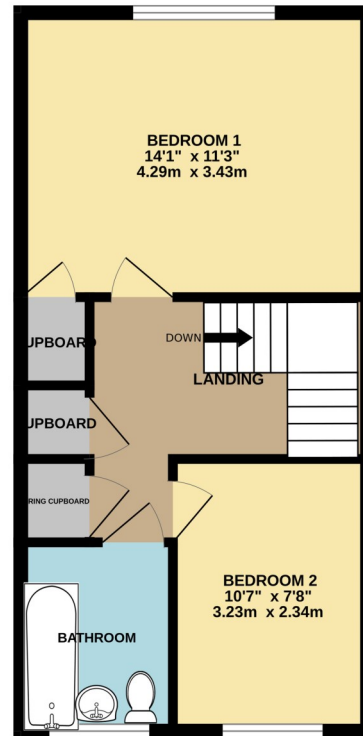
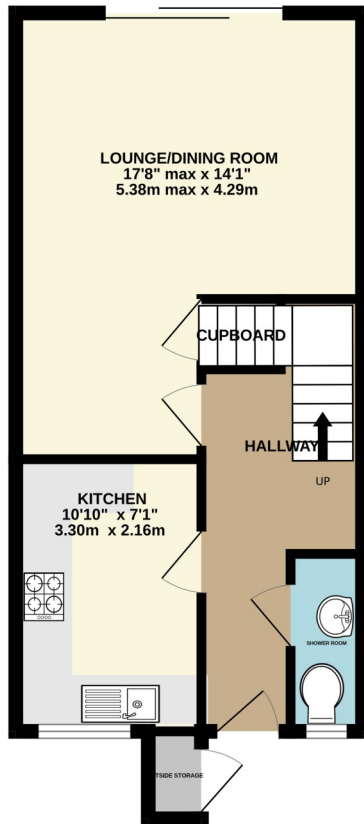

VIEWINGS

By appointment through Weller Patrick.

Tel: 01489 893555

AGENTS NOTE

Share of freehold, management fees apply

DIRECTIONS

From Bishops Waltham town centre proceed along Free Street turning right into Colville Drive. Turn right into Rareridge Lane and the property can be found on the right after a short distance.

Particulars prepared 8th May 2024

Whilst every attempt has been made to ensure the accuracy of the floorplan contained here, measurements of doors, windows, rooms and any other items are approximate and no responsibility is taken for any error, omission or mis-statement. This plan is for illustrative purposes only and should be used as such by any prospective purchaser. The services, systems and appliances shown have not been tested and no guarantee